

ZADEH RETAIL BUILDING

Located on Rye Canyon, this building is a part of a larger plan that includes the Home Depot and a Jack in the Box. This building will house a 4300 square foot Citibank and a 1200 square foot retail space. The bank's tower entrance is situated on the southwest corner of the building and is highlighted by an acrylic dome that

contrasts the otherwise rigid geometric lines of the building. Positioned close to the property line, this building embraces the space by following the diagonal property line along the western wall of the bank. This introduces a new shape to the floor plan and creates a diverse shape in the building's design.

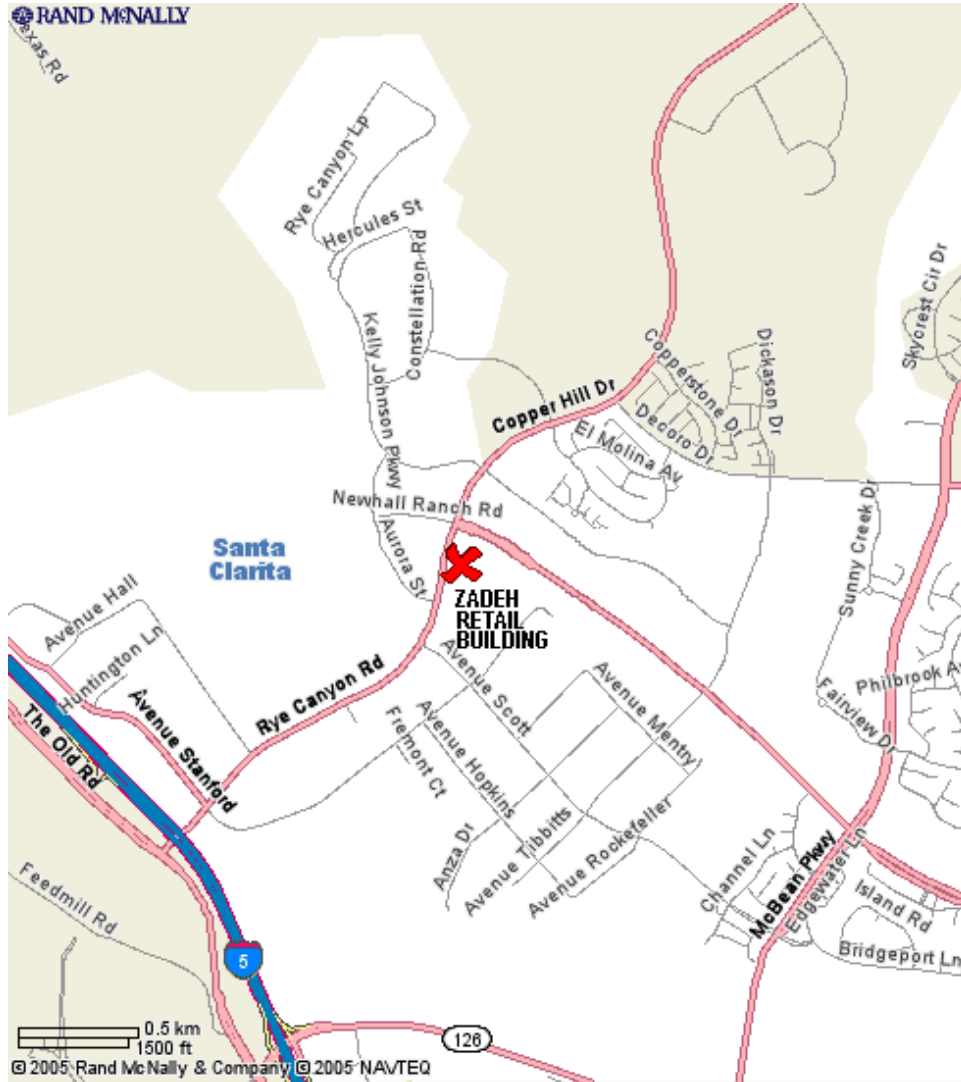



SITE MAP

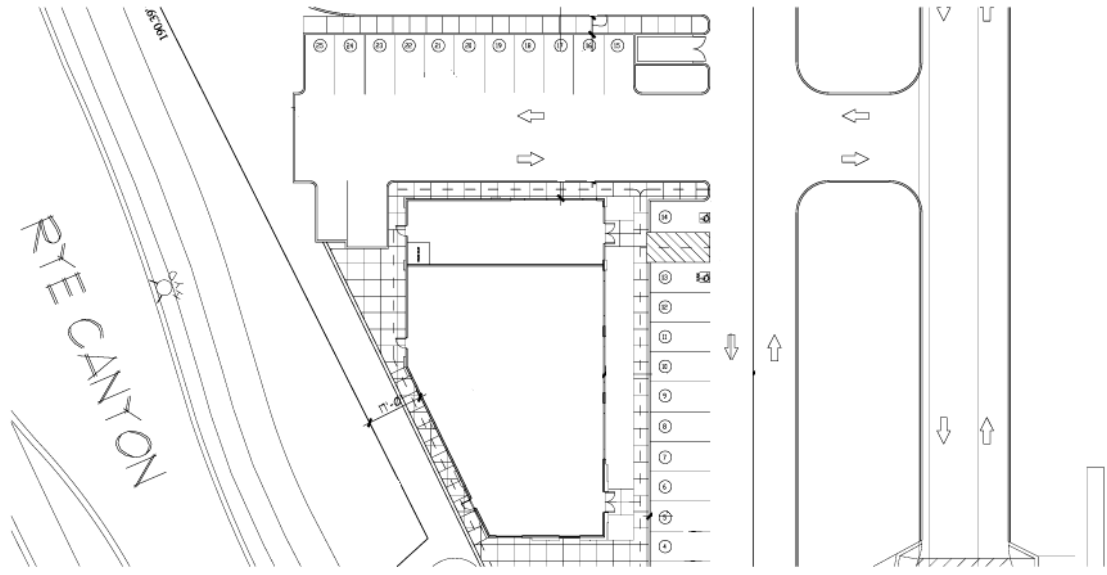

SITE PLAN

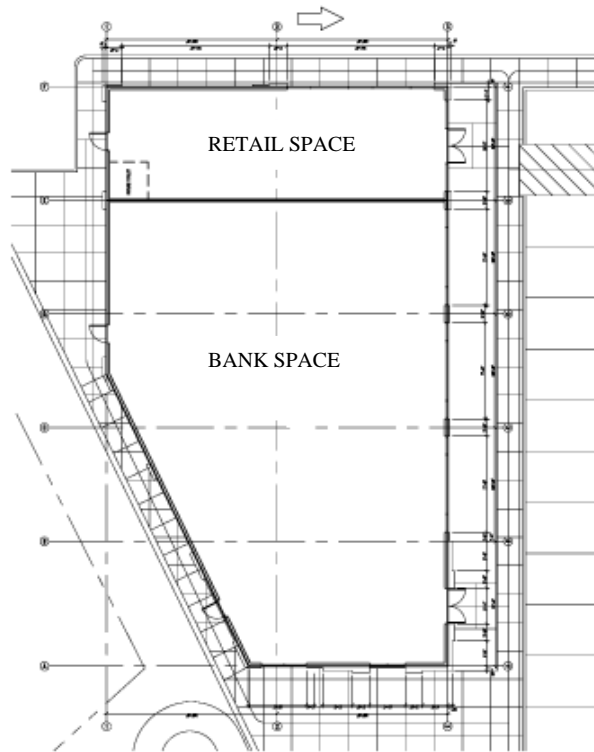

FLOOR PLAN



WEST ELEVATION



SOUTH ELEVATION

C O M B S + M I G U E L



EAST ELEVATION



NORTH ELEVATION