



## HART PARK W.M. HART HALL

### Los Angeles County

**A** multipurpose building renovated and produced in the park to accommodate meetings, group banquets, and weddings. An existing “pole building” was renovated, enclosed and up-graded to include a 2,300 square foot multipurpose room with a catering

kitchen and restrooms. The building is naturally lighted during the day by stately windows, which establish the western design theme of this park. The building is opened up visually to a landscaped patio area for an extension of the multipurpose room.







NORTHEAST ELEVATION



SOUTHWEST ELEVATION

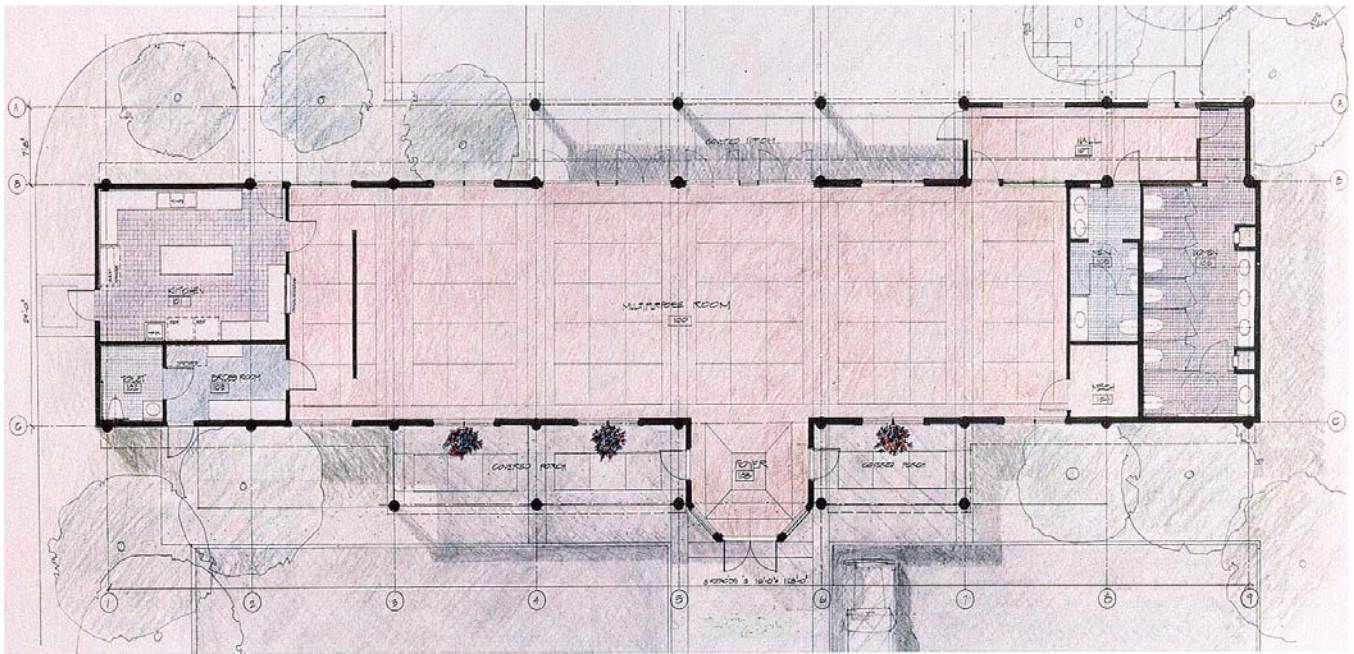

FLOOR PLAN



